

Ämne: Fastighetsreglering berörande HÖRNINGE 1:13 8:4 och 9:1 samt avstyckning från HÖRNINGE 9:1	Ämnesområde: Borgholm Borgholm Reguleringsbevis Reguleringsdatum: 1990-08-15 Reguleringsansvarig: Börje Ekelund	Ämnesområde: Kallnar
Fastighetsägare: Inger Ekelund	Ämnesområde: Kallnar	

Lotten A = Hörninge 9:15	Lotten B4 = Hörninge 9:63	Lotten 110 = Hörninge 9:82
--- L7 = --- 9:36	--- 85 = --- 9:64	--- 111 = --- 9:83
--- L8 = --- 9:37	--- 86 = --- 9:65	--- 112 = --- 9:84
--- L9 = --- 9:38	--- 92 = --- 9:66	--- 113 = --- 9:85
--- L10 = --- 9:39	--- 93 = --- 9:67	--- 114 = --- 9:86
--- L11 = --- 9:40	--- 94 = --- 9:68	
--- L12 = --- 9:41	--- 95 = --- 9:69	
--- L13 = --- 9:42	--- 96 = --- 9:70	
--- L14 = --- 9:43	--- 97 = --- 9:71	
--- L15 = --- 9:44	--- 98 = --- 9:72	
--- L16 = --- 9:45	--- 101 = --- 9:73	
--- L17 = --- 9:46	--- 102 = --- 9:74	
--- L18 = --- 9:47	--- 103 = --- 9:75	
--- L19 = --- 9:48	--- 104 = --- 9:76	
--- L20 = --- 9:49	--- 105 = --- 9:77	
--- L21 = --- 9:50	--- 106 = --- 9:78	
--- L22 = --- 9:51	--- 107 = --- 9:79	
--- L23 = --- 9:52	--- 108 = --- 9:80	
--- L24 = --- 9:53	--- 109 = --- 9:81	
--- L25 = --- 9:54		
--- L26 = --- 9:55		
--- L27 = --- 9:56		
--- L28 = --- 9:57		
--- L29 = --- 9:58		
--- L30 = --- 9:59		
--- L31 = --- 9:60		
--- L32 = --- 9:61		

EJ SKALENLIG KARTA

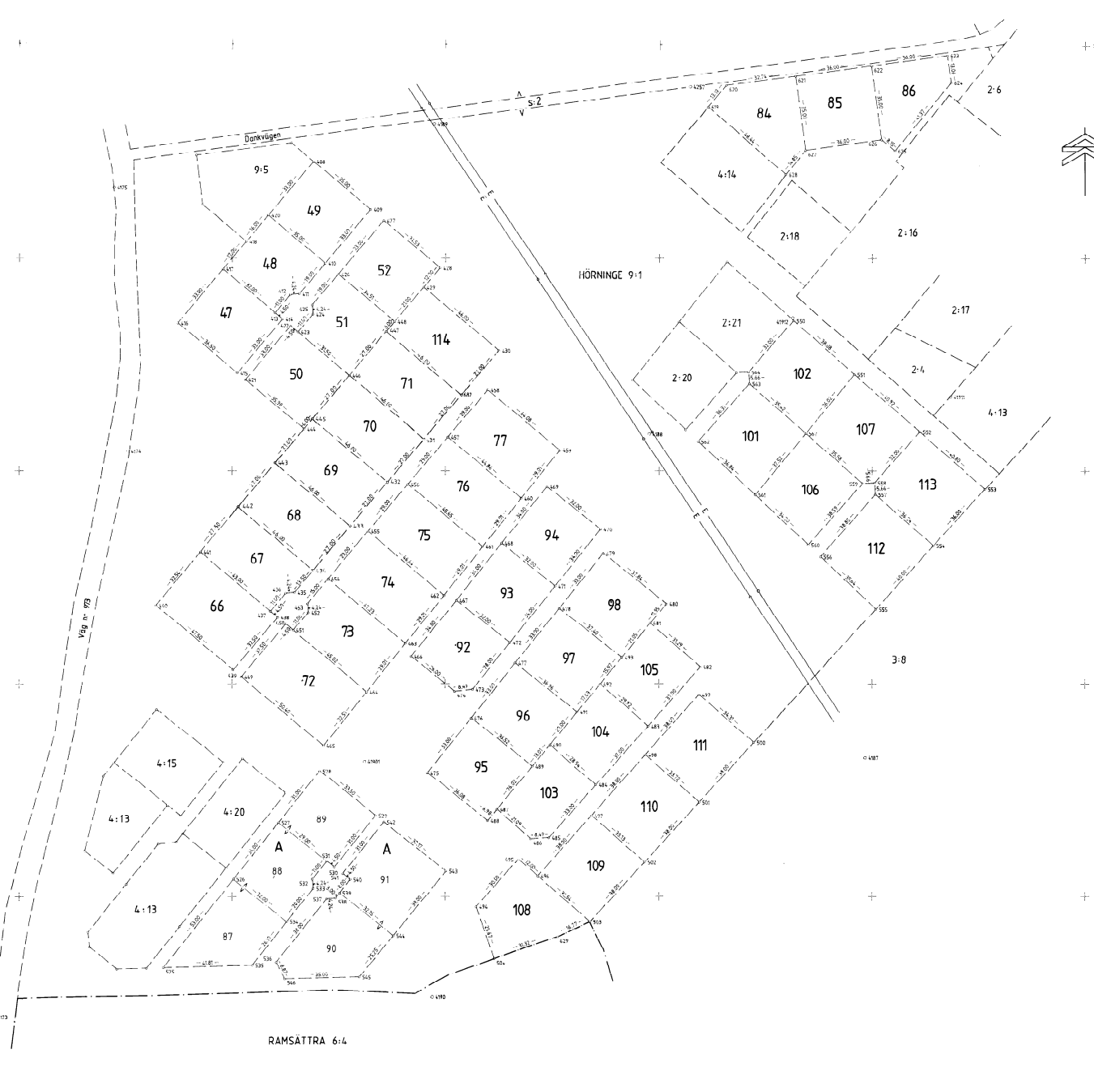

Formulär nr. 100	Formulär nr. 100	Formulär nr. 100	Formulär nr. 100
1:1000	1:1000	1:1000	1:1000
1:1000	1:1000	1:1000	1:1000
1:1000	1:1000	1:1000	1:1000

Nytilkoma gränser: Samtliga utom 408-420-418, 500-501-502-503-629-504, 550-564, 553-554-555, 619-628